



F

ROUND AIR VALVES



F-METAL



F-PVC

The air valves F are used for supply or return air applications. They are used in small rooms, WC's and corridors. They are mounted on walls or ceilings. They are manufactured from white plastic (ABS) (F-PVC) or steel painted in RAL color (F-METAL) or stainless steel (F-SS). The standard color for the steel made airvalves is white (RAL 9010) but they can be painted in other RAL colors at extra cost.

The central disc is mounted in a screw and by rotating him is moving in or out. When the central disc is in, then the air throw is vertical to the mounting surface of the air valve. When the central disc is out then the air flow is parallel to the mounting surface of the air valve, also the noise and the pressure drop are less.

The air valves are manufactured at the following nominal sizes: Ø 100, Ø 125, Ø 150 and Ø 200 (hole dimension). For their fixing in the hole an adapter is provided.

SELECTION DIAGRAMS

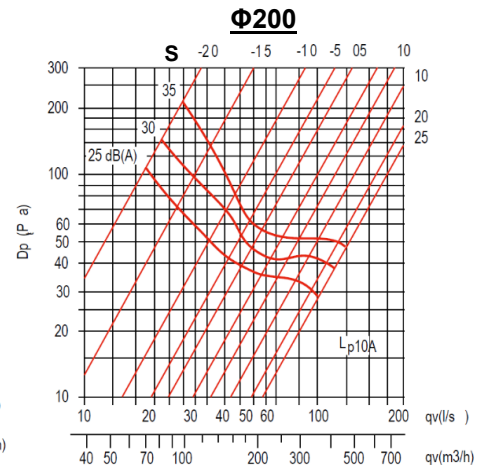
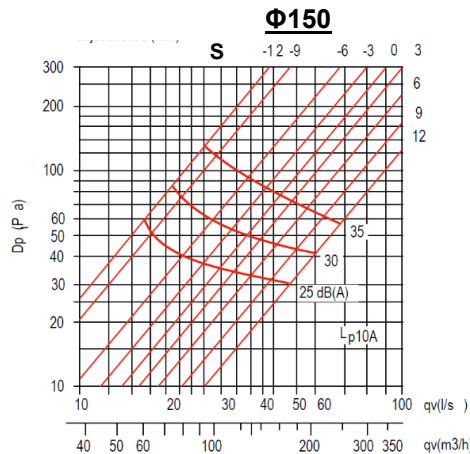
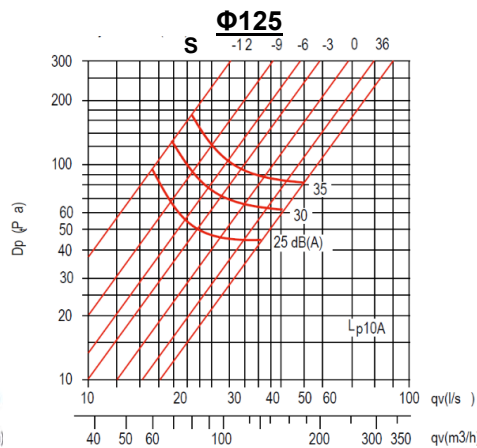
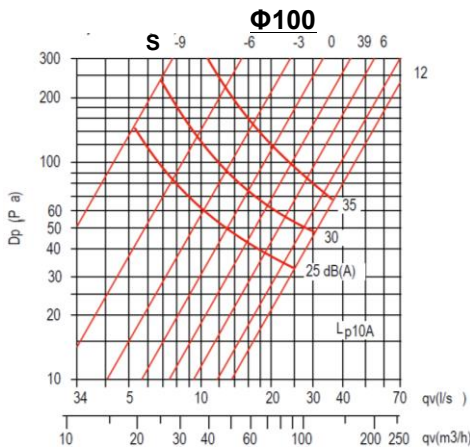

For the order must be defined the type of the air valve (F-PVC or F-METAL or F-SS), the nominal size of the air valve, and the color, if it is different from RAL 9010 (for the metal air valves only).

Order example:
F-METAL-Ø150-RAL7035.



F-SS

S: disc position



**SHAPE OF THE AIR
THROW (DEPENDS TO
THE DISC POSITION)**

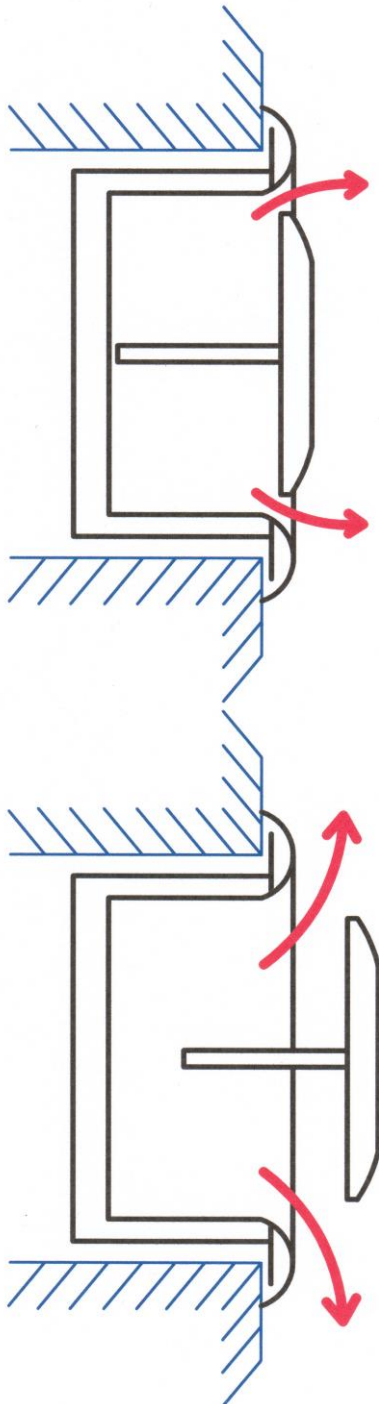

DIMENSIONS

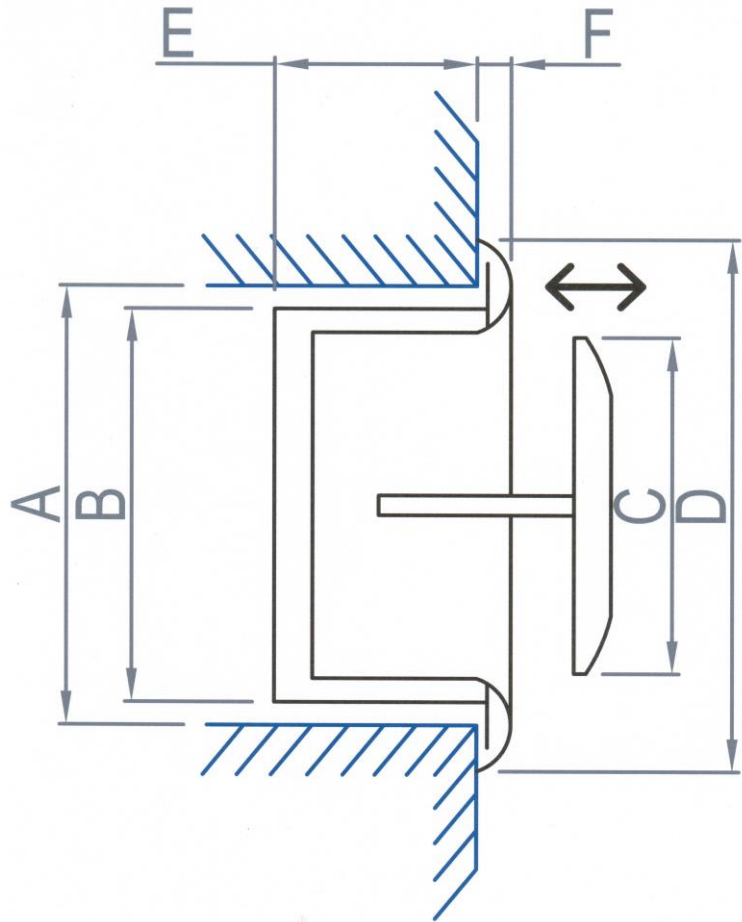

F – METAL / F - SS

SIZE	A	B	C	D	E	F
100	100	98	74	138	48	7
125	125	123	98	165	48	9
150	150	148	118	202	48	9
200	200	198	157	247	48	13

F - PVC

SIZE	A	B	C	D	E	F
100	100	98	89	149	50	20
125	125	123	109	168	50	20
150	150	148	130	185	50	20
200	200	198	178	236	50	20