

BOX BD PLUS 12/12 T6 1,1kW (251520453)

GENERAL DATA



CENTRIFUGAL FAN IN SOUNDPROOF BOX WITH SANDWICH PANELS

MANUFACTURING FEATURES

- Impellers made of polyamide reinforced with fibreglass.
- BD range fans assembled in soundproof cabinets.
- Ventilation box with 30 mm aluminum profile structure, nylon corners, galvanized sandwich panels with internal insulation rockwool (25mm thickness) class A1 (non-combustible) of 90kg/m³ density. All panels are equipped with "fastening system" for the quick assembly and disassembly whenever required, either for cleaning, maintenance or exchanging of panels.
- Connection gland included.
- Easy access through lateral panel.
- Fan can be placed in any position by exchanging panels.
- Closed motors specially designed by Casals. Extruded aluminium motor housing. Totally enclosed terminal box on the motor IP 65 protection and motor with IP54 protection and Class F insulation. Standard voltages 230V 50Hz for single phase and 230/400V 50Hz for three phase motors.

APPLICATIONS

Designed for inline installation, indoor or outdoor assembly, they are suitable for:

- Air renewal in buildings and industries.
- Maximum working temperature: 50°C.

UNDER REQUEST

- 3 speed fans.
- Impeller made of galvanized sheet.
- Rectangular outlet flange.

PERFORMANCE CURVE

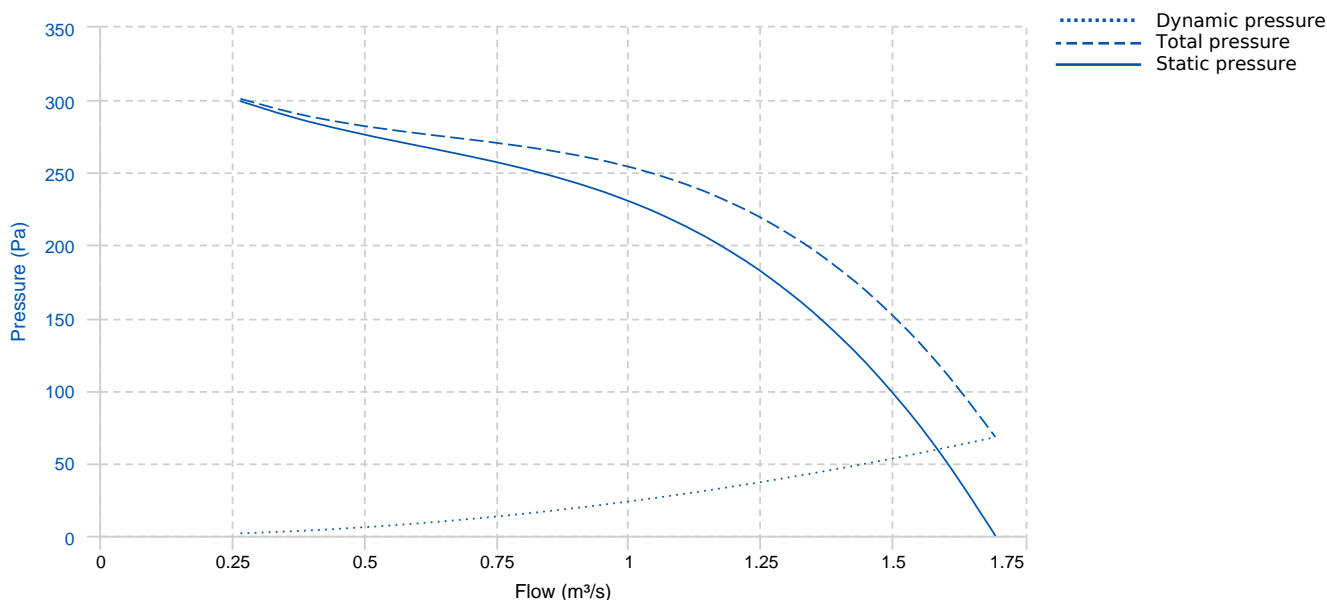

TECHNICAL DATA

| Fan | | | | | | | |
|-------|--------|----------------|---------|----------------|-----------|---------------|--------|
| RPM | 945 | Approx. weight | 54 kg | Max. Flow | 1.69 m³/s | | |
| Motor | | | | | | | |
| Power | 1,1 kW | RPM | 945 | I max. (230V) | 6,54 A | I max. (400V) | 3,78 A |
| Size | STC90 | Approx. weight | 10.6 kg | Efficiency (%) | 78.1 % | FP | 0.71 |

DIMENSIONS

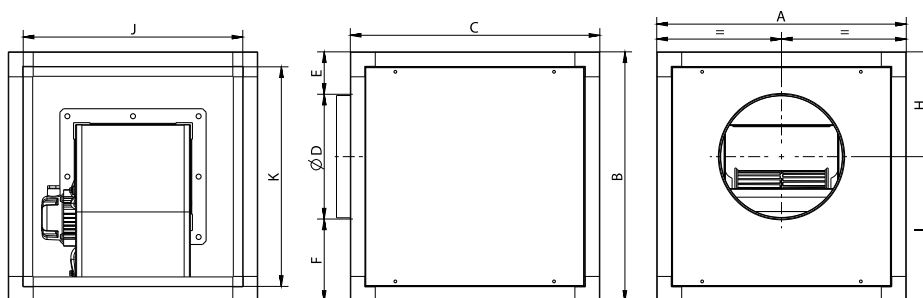

| Dimensions (mm) | | | | | | | | | |
|-----------------|-----|---|-----|---|-----|---|-----|---|-----|
| A | 700 | B | 700 | C | 700 | D | 450 | E | 80 |
| F | 170 | H | 305 | I | 395 | J | 640 | K | 640 |

WIRING DIAGRAM

230V

400V

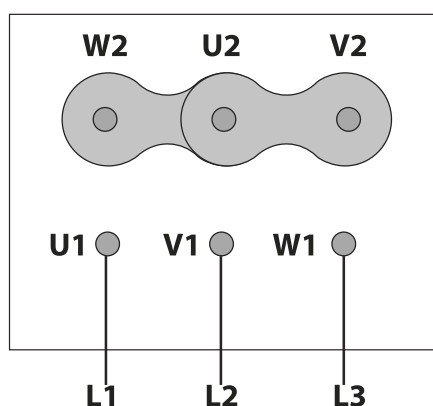
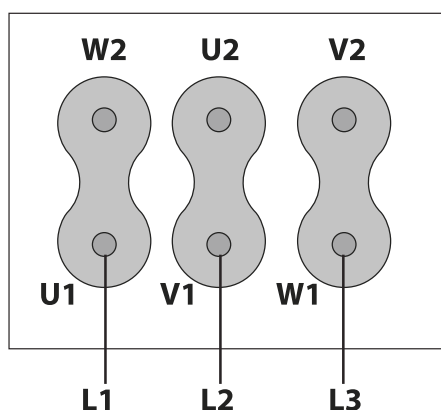

ACCESSORIES



SAFETY SWITCH
INT 25 3P A
REF: INT253PA



WEATHER PROTECTIVE ROOF FOR VENTILATION BOXES
TEJ BOX BD PLUS 12/12
REF: A-251521012



EXTERNAL BOX FILTER
BOX FILTER 700x700x300
REF: 251528471



CELL FILTER WITH GALVANIZED FRAME
FILT ISO Coarse \geq 60% (638x590x48) PREFILTRO
MARCO CHAPA
REF: FILTG04019



HIGH EFFICIENCY, RIGID AND COMPACT FILTER
FILT ePM1 \geq 50% (638x590x48) ALTA EFIC. PANEL
MINIPLGADO
REF: FILTF07030



HIGH EFFICIENCY, RIGID AND COMPACT FILTER
FILT ePM1 \geq 80% (638x590x48) ALTA EFIC. PANEL
MINIPLGADO
REF: FILTF09027



INLET/OUTLET ROUND COVER
TIAC BOX BD/BV PLUS 12/12 (Ø450)
REF: A-251521932R



CIRCULAR OUTDOOR FLANGE WITH BIRD GUARD
VISC Ø450
REF: FX0050067



FREQUENCY SPEED CONTROLLER
SFC 230 I 7A *
REF: SFC230I007



FREQUENCY SPEED CONTROLLER
SFC 400 III 5A *
REF: SFC400III5

SPARE PARTS

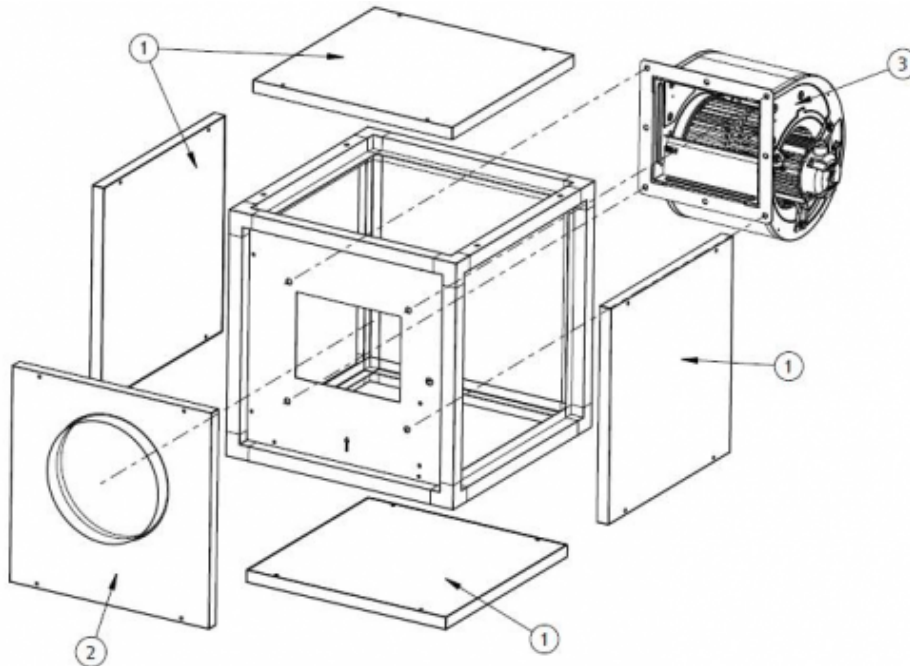

| | Code | Model | Qty |
|---|--------------|--|-----|
| 1 | R-251521931R | PANNEL BOX BD-BV PLUS 12/12 | x4 |
| 2 | R-251528901R | CIRCULAR CONNECTION BOX BD PLUS 12/12 (Ø450) | x1 |



| | Code | Model | Qty |
|---|-----------------|---------------------------|-----|
| 3 | R-251520160A002 | FAN BD 12/12 T6 1,1kW+MBI | x1 |