

BOX BD PLUS 7/7 M4 0,13kW (251100451)

GENERAL DATA



CENTRIFUGAL FAN IN SOUNDPROOF BOX WITH SANDWICH PANELS

MANUFACTURING FEATURES

- Impellers made of polyamide reinforced with fibreglass.
- BD range fans assembled in soundproof cabinets.
- Ventilation box with 30 mm aluminum profile structure, nylon corners, galvanized sandwich panels with internal insulation rockwool (25mm thickness) class A1 (non-combustible) of 90kg/m³ density. All panels are equipped with "fastening system" for the quick assembly and disassembly whenever required, either for cleaning, maintenance or exchanging of panels.
- Connection gland included.
- Easy access through lateral panel.
- Fan can be placed in any position by exchanging panels.
- Closed motors specially designed by Casals. Extruded aluminium motor housing. Totally enclosed terminal box on the motor IP 65 protection and motor with IP54 protection and Class F insulation. Standard voltages 230V 50Hz for single phase and 230/400V 50Hz for three phase motors.

APPLICATIONS

Designed for inline installation, indoor or outdoor assembly, they are suitable for:

- Air renewal in buildings and industries.
- Maximum working temperature: 50°C.

UNDER REQUEST

- 3 speed fans.
- Impeller made of galvanized sheet.
- Rectangular outlet flange.

PERFORMANCE CURVE

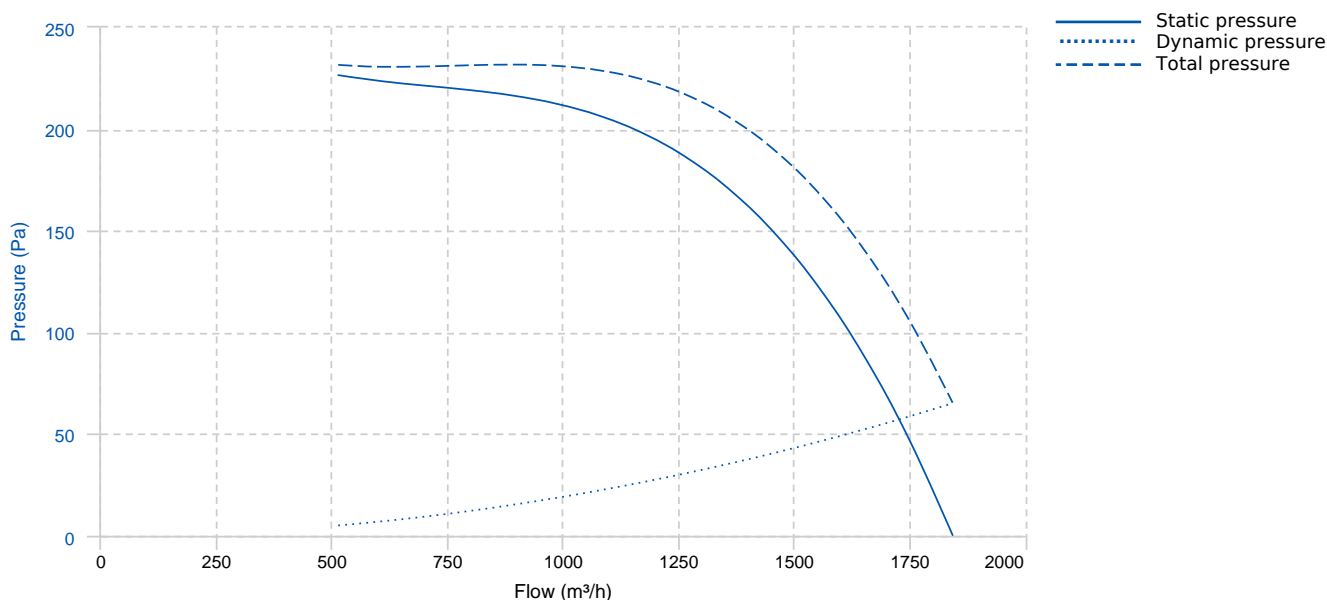

TECHNICAL DATA

Fan							
RPM	1370	Approx. weight	24 kg	Max. Flow	1850 m ³ /h		
Motor							
Power	0,13 kW	RPM	1370	Capacitor	8μF 400V	I max. (230V)	1,55 A
Size	STC63	Approx. weight	4.1 kg	Efficiency (%)	60 %	FP	0.96

ERP DATA

Fan data sheet		
Fan type	Unit for non-residential ventilation (LOT 6)	
Typology	Unidirectional	
reports.other	None	
Type of driver	None	
Motor power (kW)	0.13	
	Fan values	ERP Requirements 2018
Max. efficiency (%)	32.01	31.7
Effic. Heat recovery (%)	-	
Pabs (kW)	0.19	
Flow (m ³ /h)	1104.78	
Static pressure (Pa)	204.54	
Speed (m/s)	6.25	
SFP (W/m ³ /s)	618.38	

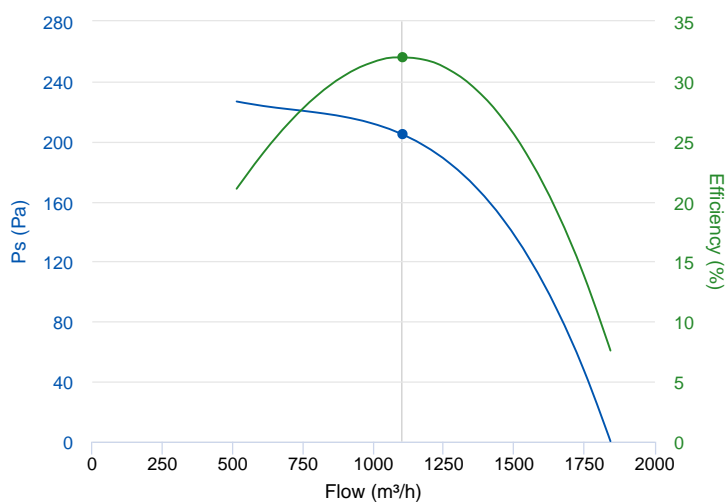

DIMENSIONS

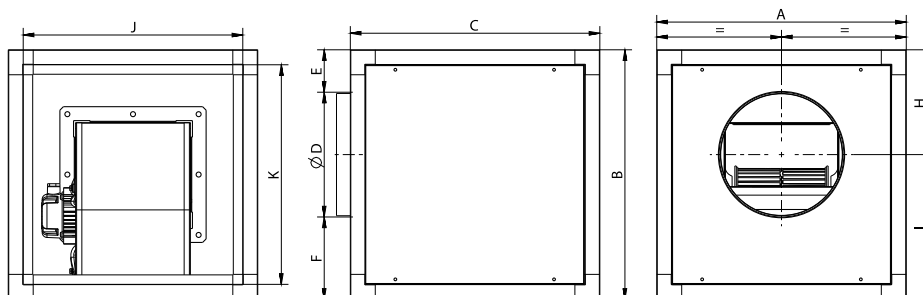

Dimensions (mm)

A	500	B	500	C	500	D	250	E	85
F	165	H	210	I	290	J	440	K	440

WIRING DIAGRAM

SINGLE PHASE MOTOR MOTOR MONOFÁSICO

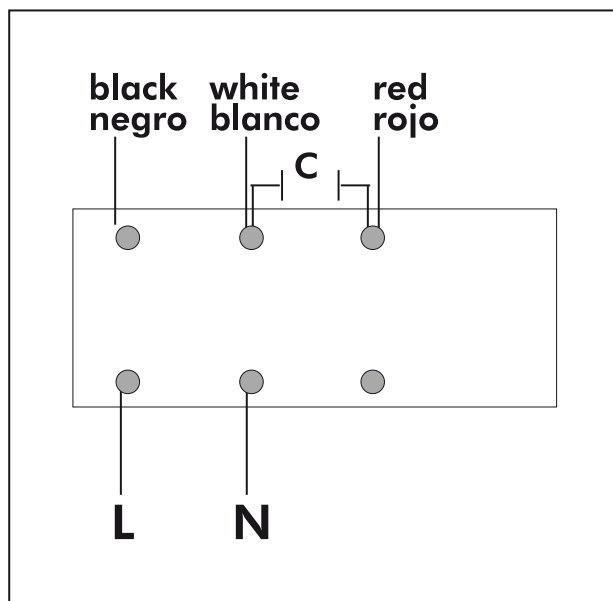

ACCESSORIES



MANUAL SINGLE PHASE SPEED CONTROLLER
REG 3A
REF: 960710030



SAFETY SWITCH
INT 25 3P A
REF: INT253PA

WEATHER PROTECTIVE ROOF FOR VENTILATION BOXES
TEJ BOX BD PLUS 7/7
 REF: 251161012

EXTERNAL BOX FILTER
BOX FILTER 500x500x300
 REF: 251168471

CELL FILTER WITH GALVANIZED FRAME
FILT ISO Coarse \geq 60% (438x390x48) PREFILTRO
MARCO CHAPA
 REF: FILTG04012

HIGH EFFICIENCY, RIGID AND COMPACT FILTER
FILT ePM1 \geq 50% (438x390x48) ALTA EFIC. PANEL
MINIPLEGADO
 REF: FILTF07025

HIGH EFFICIENCY, RIGID AND COMPACT FILTER
FILT ePM1 \geq 80% (438x390x48) ALTA EFIC. PANEL
MINIPLEGADO
 REF: FILTF09023

INLET/OUTLET ROUND COVER
TIAC BOX BD/BV PLUS 7/7 (Ø250)
 REF: 251161932R

CIRCULAR OUTDOOR FLANGE WITH BIRD GUARD
VISC Ø250
 REF: FX0045450

SPARE PARTS

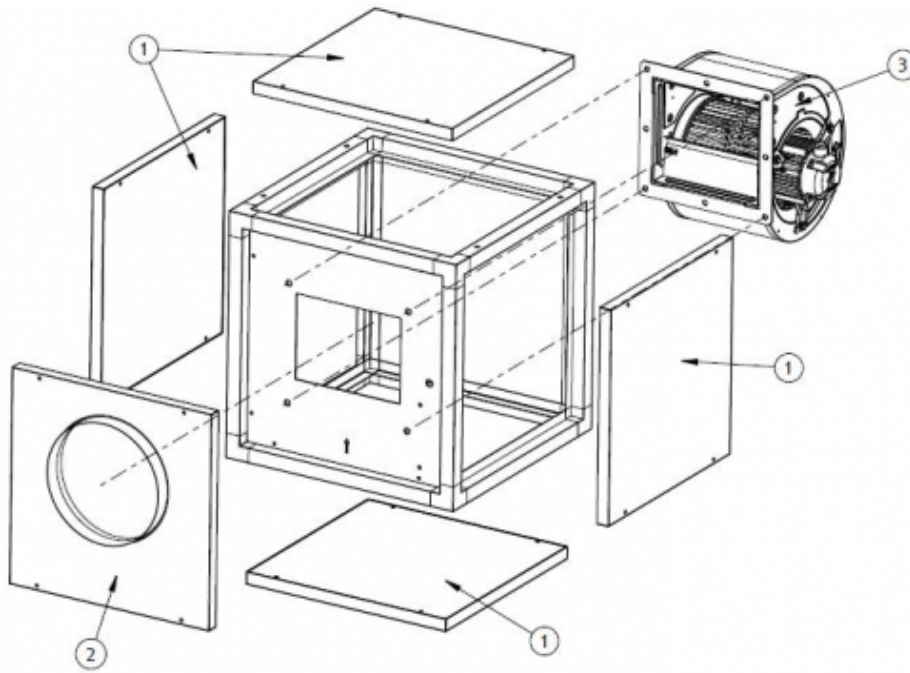

	Code	Model	Qty
1	R-251161931R	PANNEL BOX BD-BV PLUS 7/7	x4
2	R-251168901R	CIRCULAR CONNECTION BOX BD PLUS 7/7 (Ø250)	x1
3	251100261A002	FAN BD 7/7 M4 0,13kW+MBI	x1