

## BOX RLF 450 T4 1,1kW (241460186)

### GENERAL DATA



#### BACKWARD CURVED CENTRIFUGAL FAN IN SOUNDPROOF CABINET 400°C/2H

##### MANUFACTURING FEATURES

- Box manufactured in galvanised steel sheet.
- Circular inlet flange.
- Backward impeller with self-cleaning system, direct coupling motor.
- Standard asynchronous squirrel-cage motor with IP-55 protection and Class H insulation type 400°C/2h .
- Manufactured with standard voltages: 400V(Y) 50Hz in three phase motors up to 3kW and 400V(D) 50Hz for higher powers and 400V for 2 speed motors.
- Exchangeable pannels
- Open drive.

##### APPLICATIONS

Designed for inline installation, they are suitable for:

- Air renewal in buildings and industries.
- Maximum working temperature: 60°C.
- Removing smoke in case of fire. The motor inside the hazardous area (400 ° C / 2 h)

Official homologation by the European laboratory APPLUS according to EN 12101-3:2015  
Certification Nr: 0370-CPR-0582

### PERFORMANCE CURVE

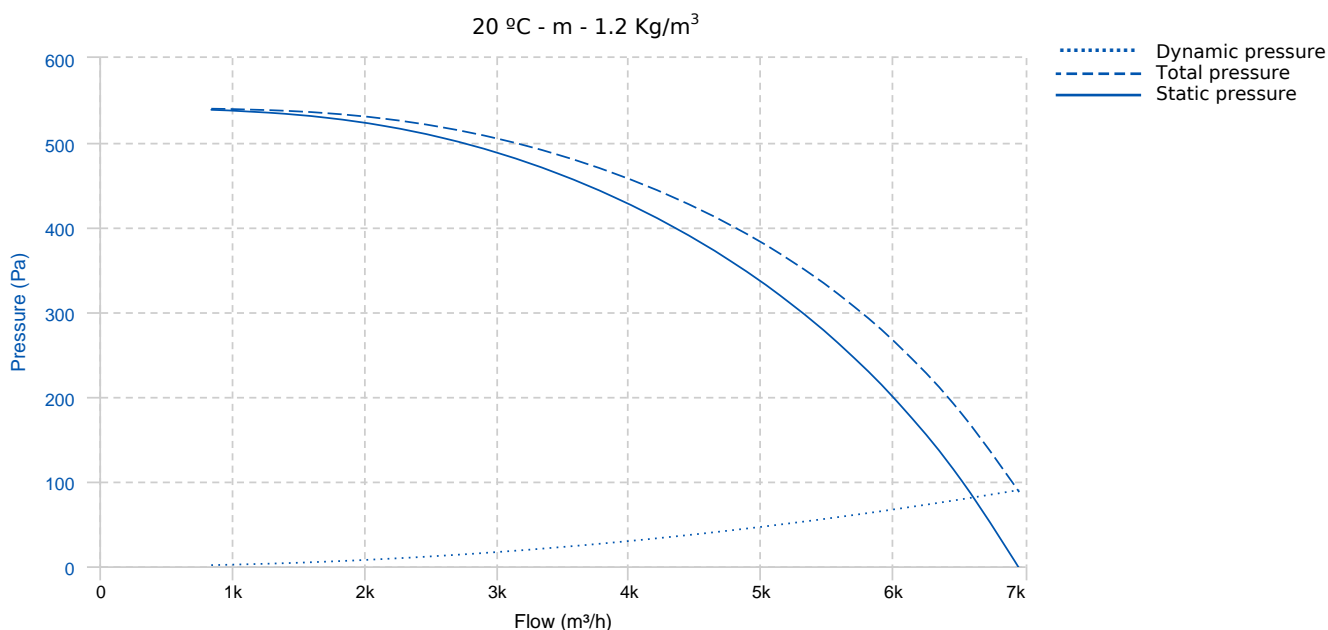

### TECHNICAL DATA

Fan							
RPM	1440	Approx. weight	142 kg	Max. Flow	6960 m³/h		
Motor							
Power	1,1 kW	RPM	1440	I max. (230V)	5,23 A	I max. (400V)	3,03 A
Size	90	Approx. weight	26 kg	Efficiency (%)	84.1 %	FP	0.76

## ERP DATA

Fan data sheet		
Fan type	Unit for non-residential ventilation (LOT 6)	
Typology	Unidirectional	
reports.other	None	
Type of driver	None	
Motor power (kW)	1.1	
	Fan values	ERP Requirements 2018
Max. efficiency (%)	55.61	41.44
Effic. Heat recovery (%)	-	
Pabs (kW)	0.914	
Flow (m³/h)	4251.47	
Static pressure (Pa)	407.55	
Speed (m/s)	7.49	
SFP (W/m3/s)	773.91	

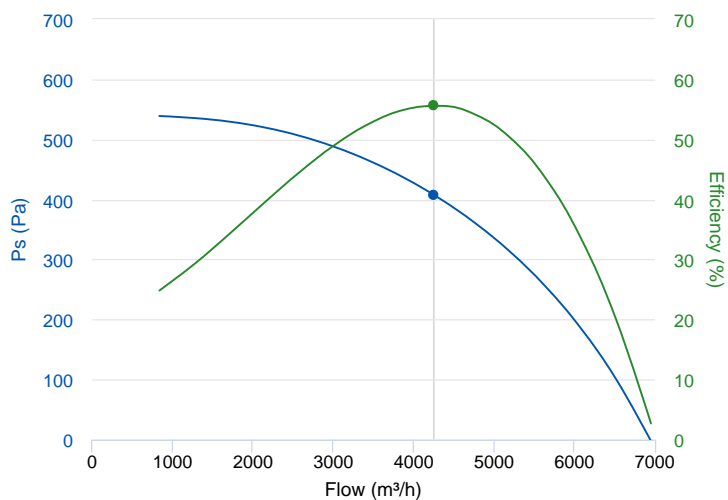

## DIMENSIONS

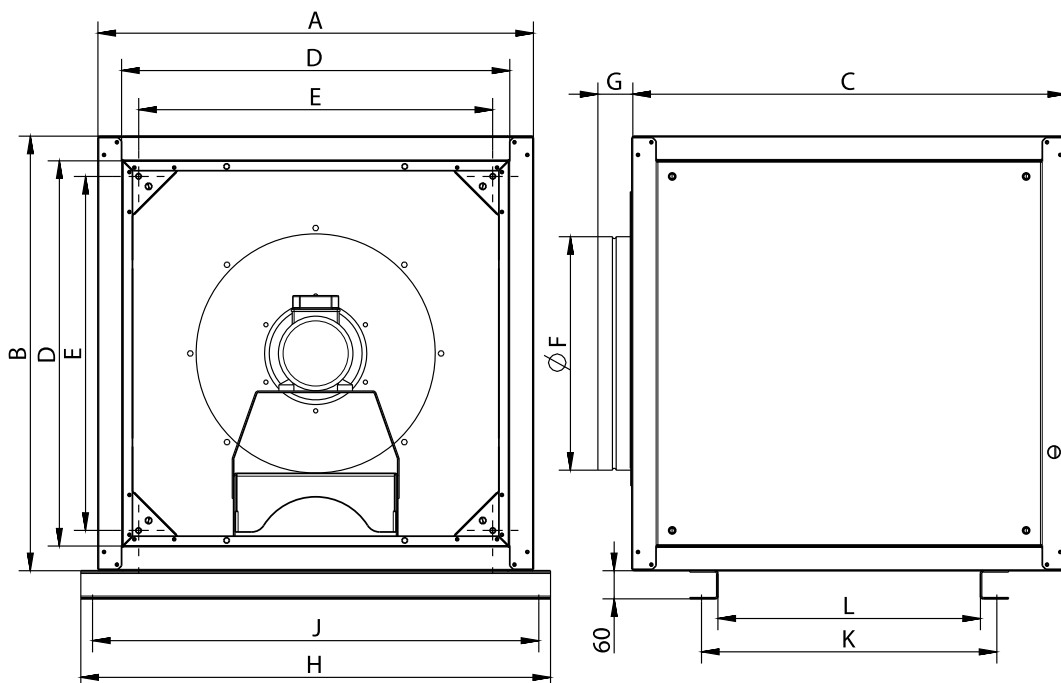

### Dimensions (mm)

A	800	B	800	C	800	D	696	E	628,5
G	74	H	1002	J	952	K	628,5	L	558,5
ØF	448								

**WIRING DIAGRAM**

230V 

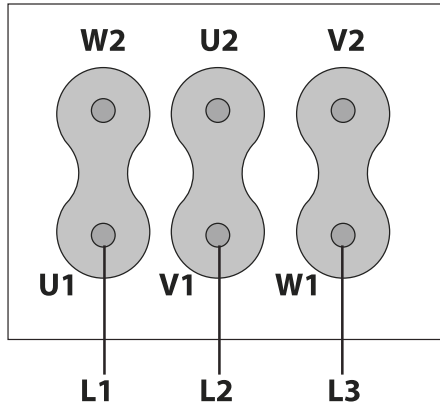

400V 

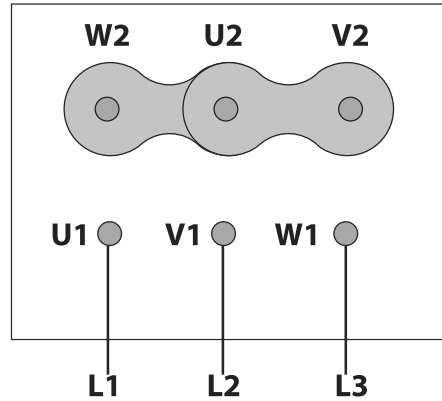

**ACCESSORIES**



**SAFETY SWITCH**  
INT 25 3P A  
REF: INT253PA



**ANTI-VIBRATING FLANGE 400°/2H**  
BA-400 45  
REF: 960002055



**ANTI-VIBRATION JOINT**  
JE 45  
REF: A-300719201



**INLET/OUTLET ROUND COVER**  
TIAC 45  
REF: 960001945



**CIRCULAR SILENCER**  
SIL-C 450/450  
REF: 960045045

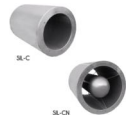

**CIRCULAR SILENCER**  
SIL-C 450/ 675  
REF: 960045675



**CIRCULAR SILENCER**  
SIL-CN 450/900  
REF: 960045090



**CIRCULAR SILENCER**  
SIL-CN 450/450  
REF: 961045045



**CIRCULAR SILENCER**  
SIL-CN 450/ 675  
REF: 961045675



**SAFETY SWITCH FOR 400°C/2h**  
INT 400 25A 3P  
REF: 508902501



**FREQUENCY SPEED CONTROLLER**  
**SFC 400 III 3,6A \***  
**REF: SFC400III4**

## SPARE PARTS

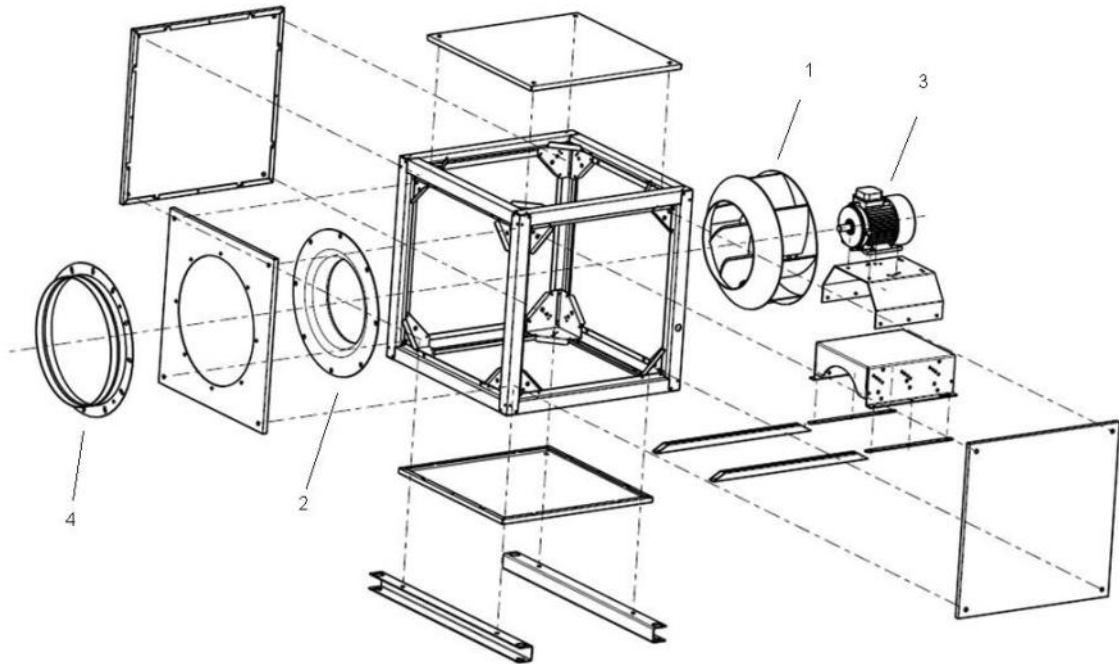

	Code	Model	Qty
3	721881150	MOTOR 1,1KW T4 B3 400G	x1
4	960003213	FLANGE AC-450	x1