

# HJBM PLUS 40 M4 0,25kW (268403103)

## GENERAL DATA



SQUARE WALL PLATE FAN, VARIABLE PITCH BLADES AND HIGH EFFICIENCY MOTOR

### MANUFACTURING FEATURES

- Square plate made of galvanized steel sheet with polyester painting.
- Variable pitch angle polyamide impeller reinforced with fibreglass.
- Supplied with motor support and protection guard according to the UNE-EN 20-359-74 norm and the ROHS 2002/95/EC Directive (Restriction of the Use of Certain Hazardous Substances in Electrical and Electronic Equipments).
- High efficiency standard asynchronous squirrel-cage motor with IP-55 or IP-54 protection (wiring box IP-65) and Class F insulation. Manufactured with standard voltages: 230V 50Hz for the single phase motors and 230/400V 50Hz for the three phase motors.

### APPLICATIONS

Designed for wall assembly, they are suitable for:

- Air renewal in buildings and industries.
- Maximum working temperature: single phase 50°C, three phase 60°C.

### UNDER REQUEST

- Aluminium impeller.
- 60Hz fans.

## PERFORMANCE CURVE

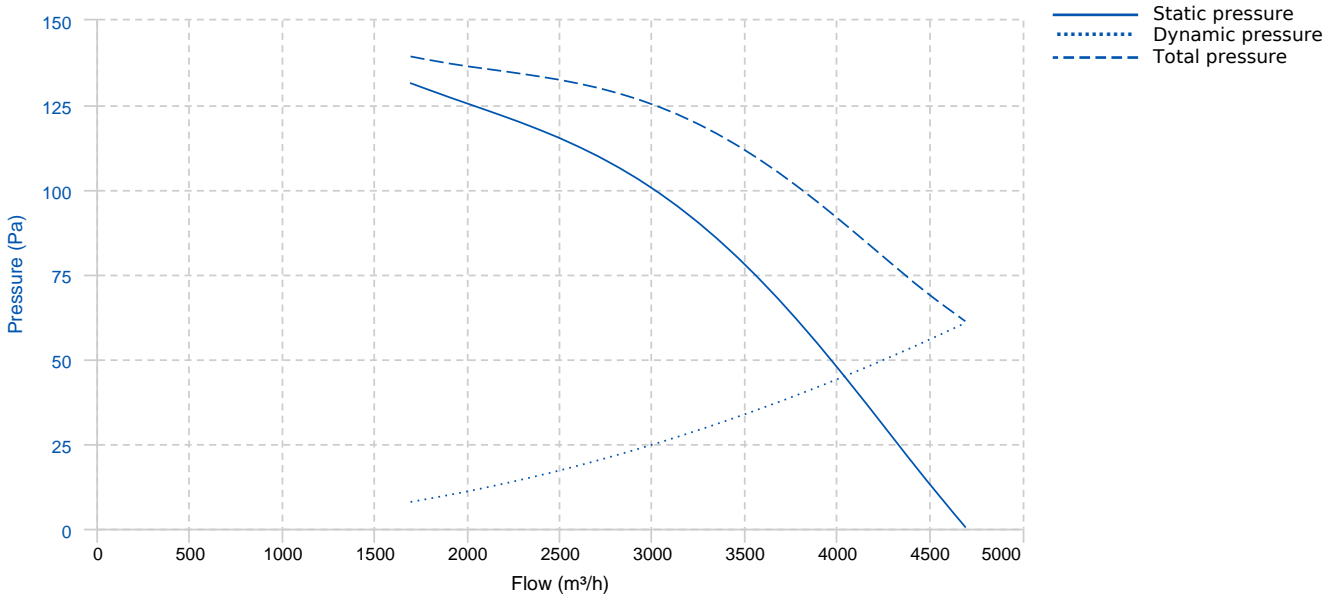

## TECHNICAL DATA

| Fan   |         |                |        |                |           |               |       |
|-------|---------|----------------|--------|----------------|-----------|---------------|-------|
| RPM   | 1410    | Approx. weight | 9 kg   | Max. Flow      | 4700 m³/h |               |       |
| Motor |         |                |        |                |           |               |       |
| Power | 0,25 kW | RPM            | 1410   | Capacitor      | 12µF 450V | I max. (230V) | 1,6 A |
| Size  | 71      | Approx. weight | 6.5 kg | Efficiency (%) | 68,5 %    | FP            | 0,99  |

## DIMENSIONS

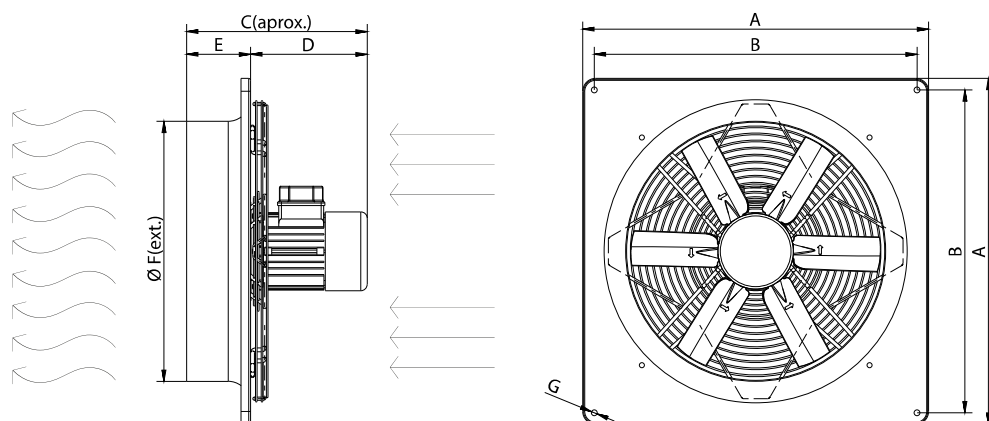

### Dimensions (mm)

|    |     |    |     |   |     |   |     |   |     |
|----|-----|----|-----|---|-----|---|-----|---|-----|
| A  | 540 | B  | 504 | C | 312 | D | 212 | E | 100 |
| ØF | 406 | ØG | 11  |   |     |   |     |   |     |

## WIRING DIAGRAM

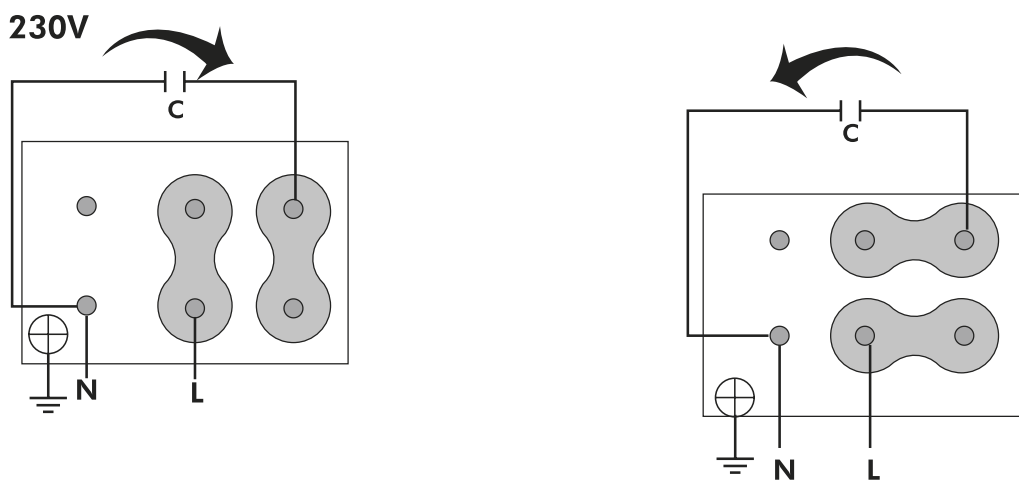

## ACCESSORIES



**SAFETY SWITCH**  
**INT 25 3P A**  
REF: INT253PA



**Outlet protection guard for axial fans**  
**RP0 40**  
REF: 980000040



**PLASTIC GRAVITY SHUTTER**  
**PCP 40**  
REF: 963230106G



**ALUMINIUM GRAVITY SHUTTER**  
**PC2 40**  
REF: PC24040

## SPARE PARTS

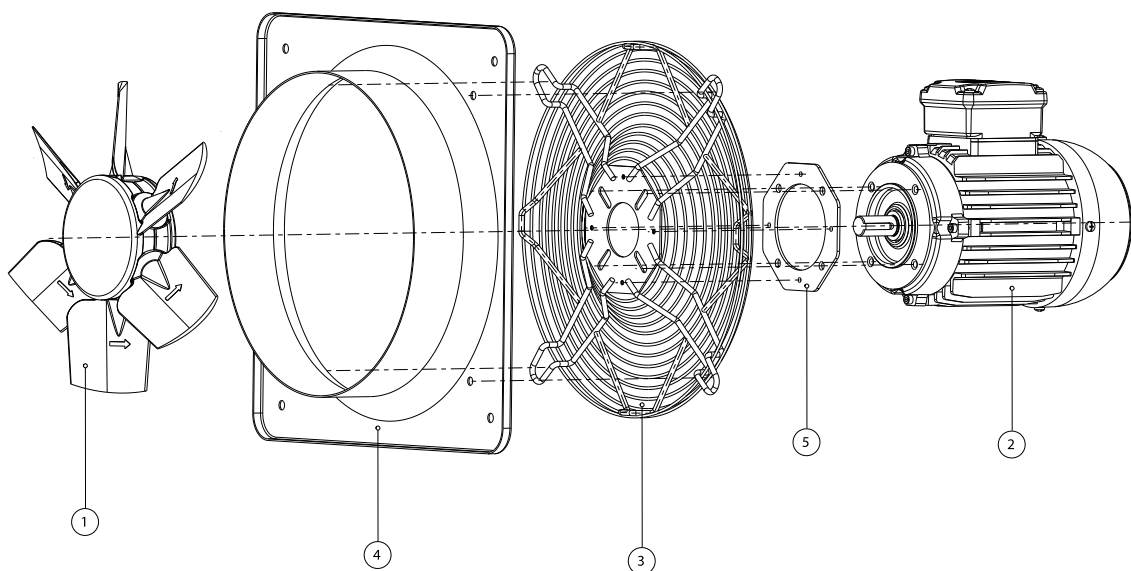

|   | Code            | Model                                      | Qty |
|---|-----------------|--|-----|
| 1 | R-H40006240PSTD | IMPELLER 400:AP0:6 G40 D14                 | x1  |
| 2 | 720301125       | MOTOR 0,25KW.1500 B14 230V.                | x1  |
| 3 | R-268401902     | PROTECTION GRID HJBM40                     | x1  |
| 4 | R-268401779A001 | FRAME HJBM-HJBM EEC40                      | x1  |
| 5 | R-268351909     | SUPPORT MOTOR DISC HJBM25-30-35-40-45 T.71 | x1  |