

## MB 16/6 T2 0,37kW (253110106)

### GENERAL DATA



#### MEDIUM PRESSURE CENTRIFUGAL FAN WITH FORWARD IMPELLER

##### MANUFACTURING FEATURES:

- Rolling steel sheet housing.
  - Completely joined or welded housing.
  - Galvanised steel sheet simple inlet forward curved impeller.
  - Polyester powder finishing coat.
  - Standard asynchronous squirrel-cage motor with IP-55 protection and Class F insulation.
- Manufactured with standard voltages: 230V 50Hz in single phase motors and 230/400V 50Hz in three phase motors.

- Available positions (to be indicated in case of order): LG270, LG0, LG45, LG90, LG135, LG180, LG225, LG315, RD0, RD45, RD90, RD135, RD180, RD225, RD270, RD315.
- The indicated codes correspond to the model in position LG270

##### APPLICATIONS:

Designed for inline installation, they are suitable for:

- Industrial applications, extraction or injection of air.
- Cooling of machines and parts.
- Suitable for transporting totally clean air without dust.
- Maximum working temperature: carried air: 130°C, environment single phase 50°C, three phase 60°C.

##### UNDER REQUEST:

- Special voltages.
- 2 speed motors (three phase motors).
- Fan for air working temperatures up to 250°C.
- Fans provided with cooling disk for high temperature.
- Option with support for models where it is not included, and without support for models where it is included.

## PERFORMANCE CURVE

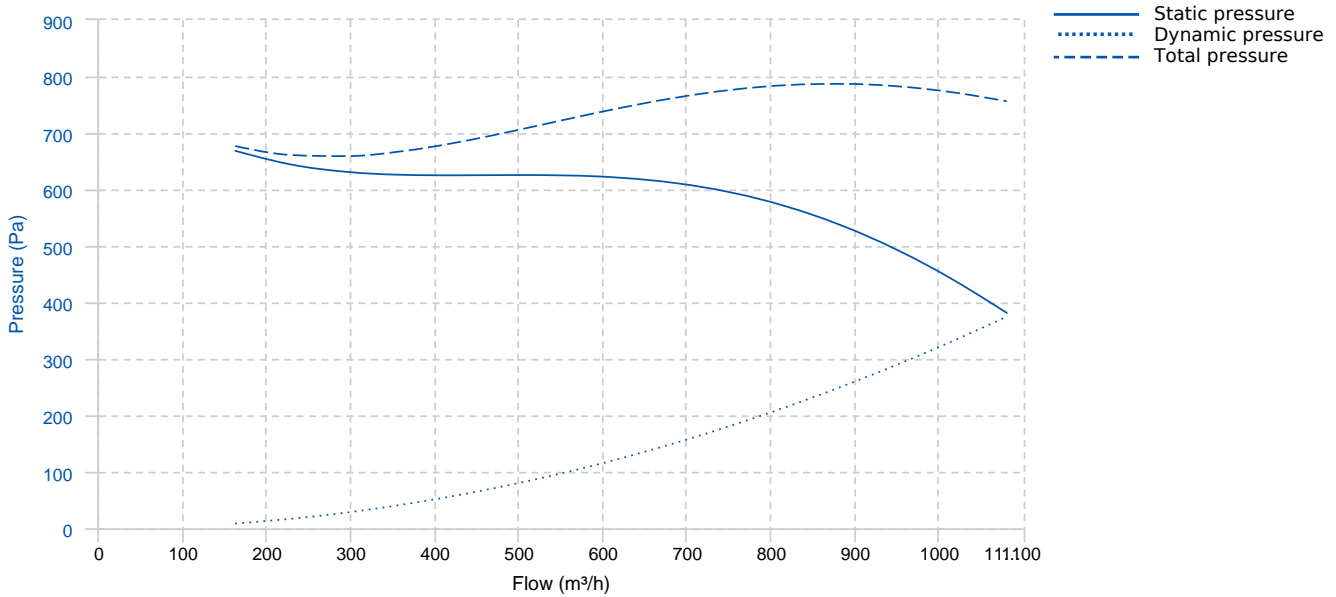

## TECHNICAL DATA

Fan							
RPM	2800	Approx. weight	9.5 kg	Max. Flow	1080 m³/h		
Motor							
Power	0,37 kW	RPM	2800	I max. (230V)	1,58 A	I max. (400V)	0,91 A
Size	71	Approx. weight	5.7 kg				

## ERP DATA

Fan data sheet		
Fan type	Centrifugal fan radial or forward blades	
Installation category	B: Inlet free, Ducted outlet	
Efficiency category	Total	
The fan has to be installed with VF	No	
Motor power (kW)	0.37	
	Fan values	ERP Requirements 2015
Max. efficiency (%)	46.55	40.25
Efficiency grade (N)	55.3	49
Pabs (kW)	0.414	
Flow (m³/h)	878.63	
Total pressure (Pa)	787.31	
Speed (m/s)	2800	

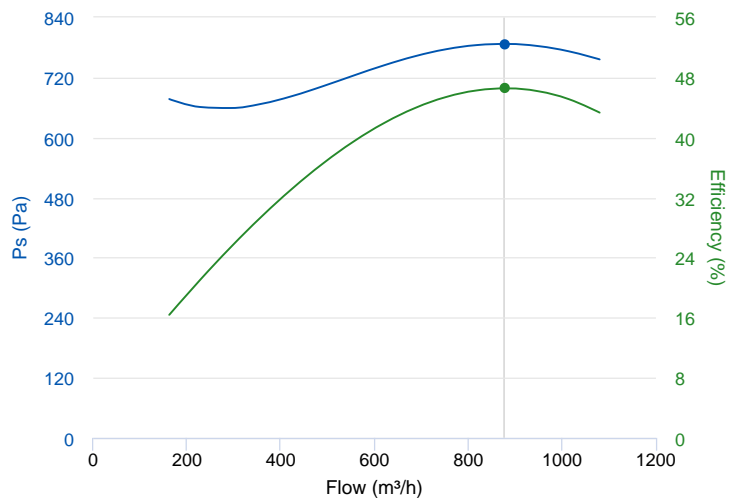

Fan values	ERP Requirements 2015
------------	-----------------------

Specific ratio	1.00
----------------	------

## DIMENSIONS

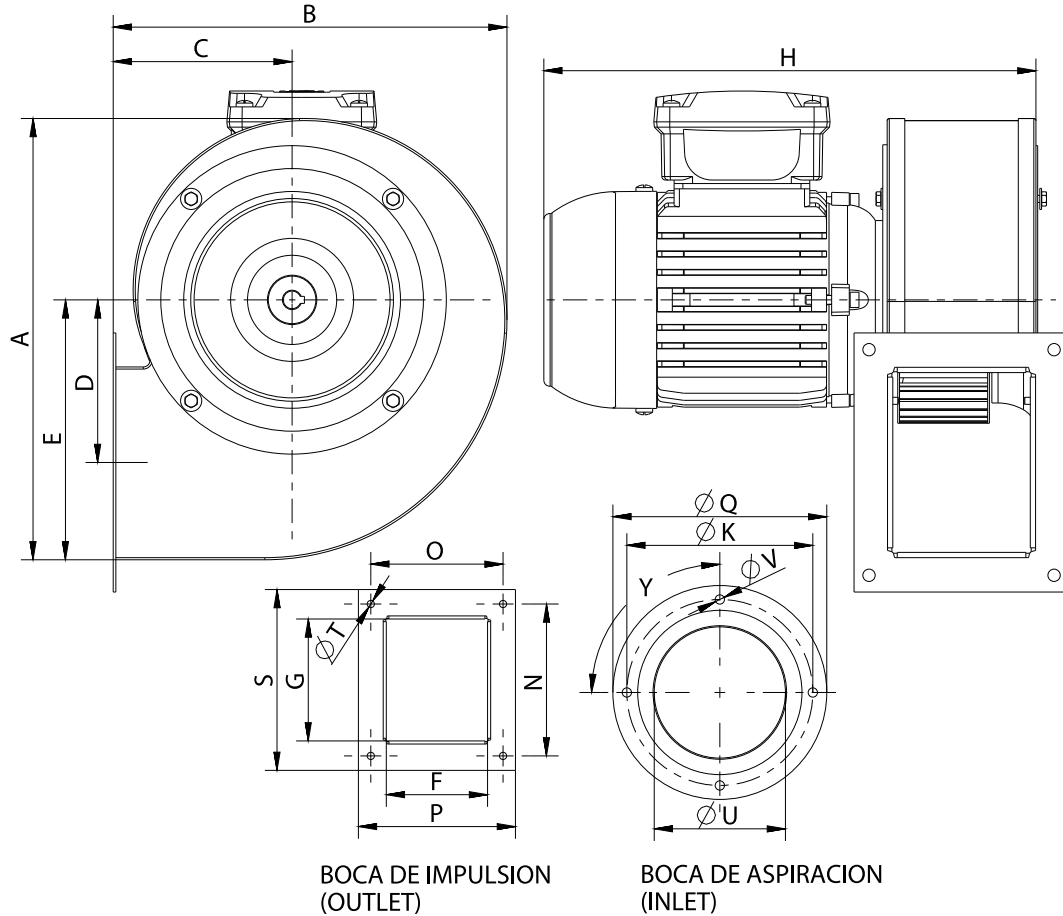

Dimensions (mm)									
A	295	B	266	C	119	D	108,5	E	171,5
F	98	G	118	H	325	K	180	N	147
O	128	P	152	Q	207	S	175	TØ	7
UØ	127	VØ	9	Y	4x90°				

## WIRING DIAGRAM

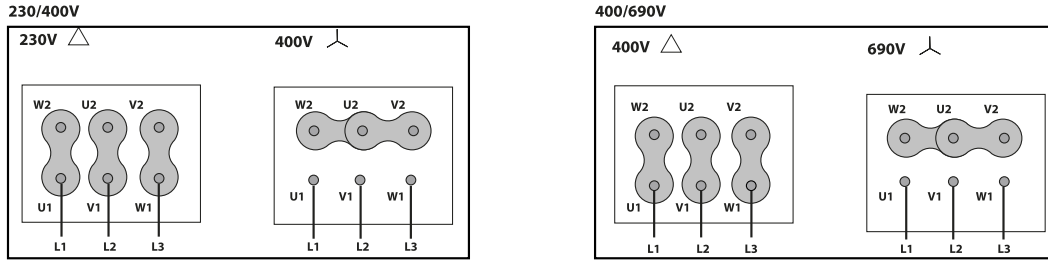

## ACCESSORIES



**SAFETY SWITCH**  
INT 25 3P A  
REF: INT253PA



**INLET PROTECTION GUARD FOR CENTRIFUGAL FANS**  
RA 16/6  
REF: A-253111901



**CIRCULAR OUTLET CONNECTION FLANGE**  
EI 16/6  
REF: 962160111



**ANTI-VIBRATING FLANGE 400°/2H**  
BA-400 15/16  
REF: 960002067



**ANTI-VIBRATION JOINT**  
JE 45  
REF: 300719201



**CONNECTION FLANGE**  
AC 150  
REF: 960003204



**OUTLET PROTECTION GUARD**  
RBS 16/6  
REF: A-960000354



**FREQUENCY SPEED CONTROLLER**  
SFC 230 I 2,5A \*  
REF: SFC230I003



**FREQUENCY SPEED CONTROLLER**  
SFC 400 III 1,2A \*  
REF: SFC400III1



**ACOUSTIC CABINS FOR CENTRIFUGAL FANS**  
AB (GENERIC)

**SPARE PARTS**

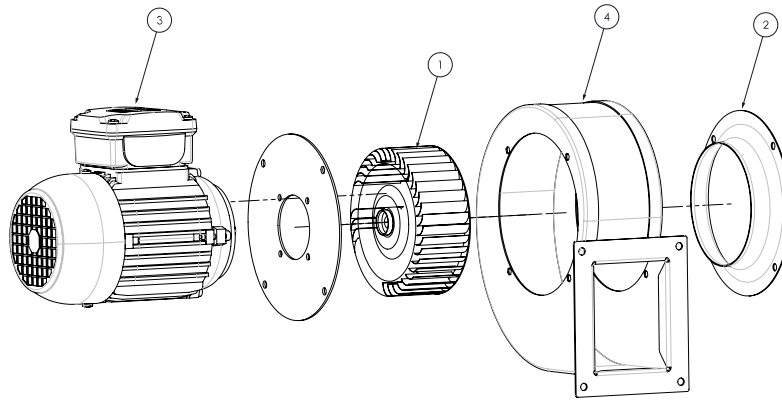

	Code	Model	Qty
1	R-253119382	TURBINE GALV.160X62X14 LG	x1
2	R-253111681	INLET CONE MB16/6	x1
3	721001024	MOTOR 0,37kW T2 B14 230/400V	x1
4	R-253119421	CASING MB 16/6	x1