

MB 18/7 T2 0,75kW (253170106)

GENERAL DATA



MEDIUM PRESSURE CENTRIFUGAL FAN WITH FORWARD IMPELLER

MANUFACTURING FEATURES:

- Rolling steel sheet housing.
 - Completely joined or welded housing.
 - Galvanised steel sheet simple inlet forward curved impeller.
 - Polyester powder finishing coat.
 - Standard asynchronous squirrel-cage motor with IP-55 protection and Class F insulation.
- Manufactured with standard voltages: 230V 50Hz in single phase motors and 230/400V 50Hz in three phase motors.

- Available positions (to be indicated in case of order): LG270, LG0, LG45, LG90, LG135, LG180, LG225, LG315, RD0, RD45, RD90, RD135, RD180, RD225, RD270, RD315.
- The indicated codes correspond to the model in position LG270

APPLICATIONS:

Designed for inline installation, they are suitable for:

- Industrial applications, extraction or injection of air.
- Cooling of machines and parts.
- Suitable for transporting totally clean air without dust.
- Maximum working temperature: carried air: 130°C, environment single phase 50°C, three phase 60°C.

UNDER REQUEST:

- Special voltages.
- 2 speed motors (three phase motors).
- Fan for air working temperatures up to 250°C.
- Fans provided with cooling disk for high temperature.
- Option with support for models where it is not included, and without support for models where it is included.

PERFORMANCE CURVE

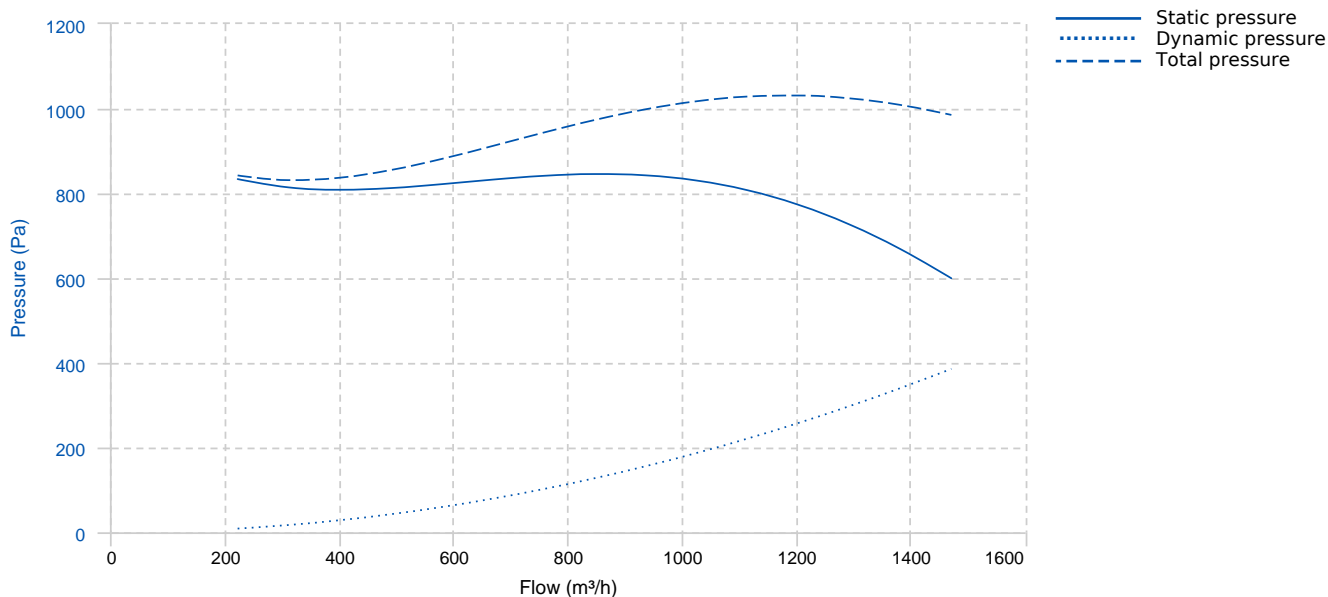

TECHNICAL DATA

Fan							
RPM	2800	Approx. weight	15 kg	Max. Flow	1470 m³/h		
Motor							
Power	0,75 kW	RPM	2800	I max. (230V)	2,75 A	I max. (400V)	1,58 A
Size	80	Approx. weight	12.5 kg	Efficiency (%)	80.7 %	FP	0.86

ERP DATA

Fan data sheet		
Fan type	Centrifugal fan radial or forward blades	
Installation category	B: Inlet free, Ducted outlet	
Efficiency category	Total	
The fan has to be installed with VF	No	
Motor power (kW)	0.75	
	Fan values	ERP Requirements 2015
Max. efficiency (%)	47.11	41.77
Efficiency grade (N)	54.34	49
Pabs (kW)	0.72	
Flow (m³/h)	1179.73	
Total pressure (Pa)	1031.87	
Speed (m/s)	2800	

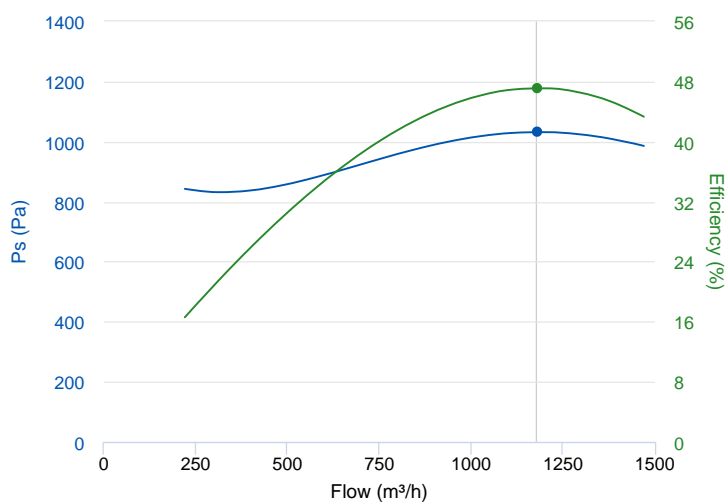

Fan values	ERP Requirements 2015
------------	-----------------------

Specific ratio	1.00
----------------	------

DIMENSIONS

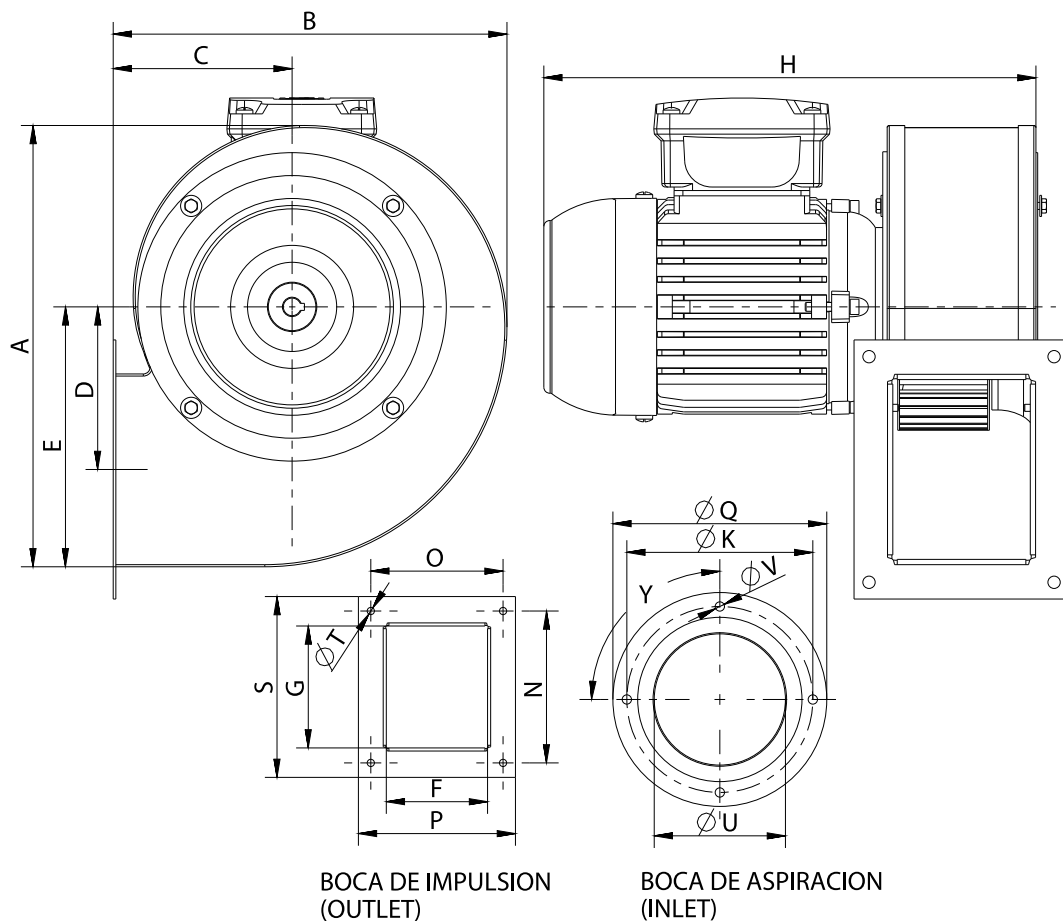

Dimensions (mm)									
A	365	B	321	C	139	D	141,5	E	213
F	115	G	141,5	H	360	K	214	N	169
O	146	P	169	Q	237	S	192	TØ	9
UØ	143	VØ	9	Y	4x90°				

WIRING DIAGRAM

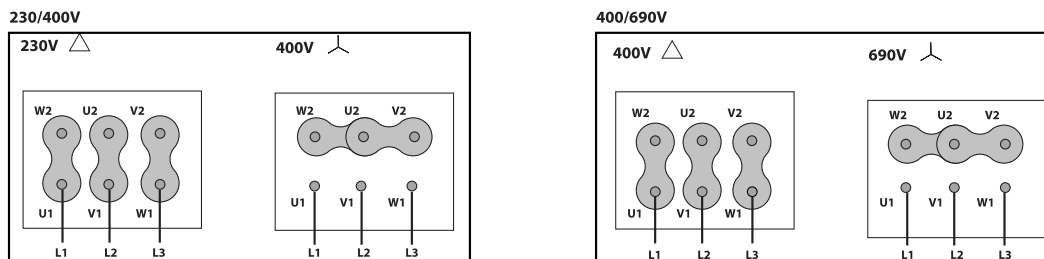

ACCESSORIES



SAFETY SWITCH
INT 25 3P A
REF: INT253PA



CIRCULAR OUTLET CONNECTION FLANGE
EI 18/7
REF: 962180111



ANTI-VIBRATION JOINT
JE 45
REF: 300719201



OUTLET PROTECTION GUARD
RBS 18/7
REF: A-960000355



FREQUENCY SPEED CONTROLLER
SFC 400 III 2,2A *
REF: SFC400III2



INLET PROTECTION GUARD FOR CENTRIFUGAL FANS
RA 18/7
REF: A-253171901



ANTI-VIBRATING FLANGE 400°/2H
BA-400 20
REF: 960002066



CONNECTION FLANGE
AC 175
REF: 960003205



FREQUENCY SPEED CONTROLLER
SFC 230 I 4,2A *
REF: SFC230I004



ACOUSTIC CABINS FOR CENTRIFUGAL FANS
AB (GENERIC)

SPARE PARTS

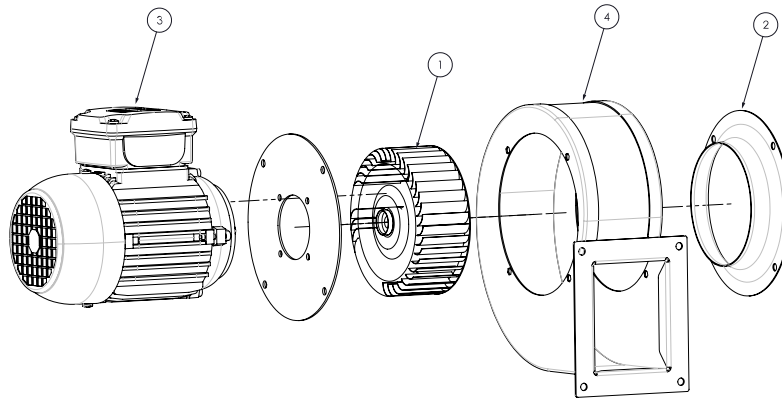

	Code	Model	Qty
1	R-253179381	TURBINE GALV.180X74X19 LG	x1
2	R-253171681	INLET CONE MB18/7	x1
3	721001037	MOTOR 0,75kW T2 B14 230/400V	x1
4	R-253179421	CASING MB 18/7	x1